

## Manual cone pull-down zero point locator

Realize interference free cylindrical pull-down fixture for five sided machining



### Manual cone pull-down zero locator series



### Manual cone pull-down locator accessory



Manual cone pull-down installation method:

Single head installation method

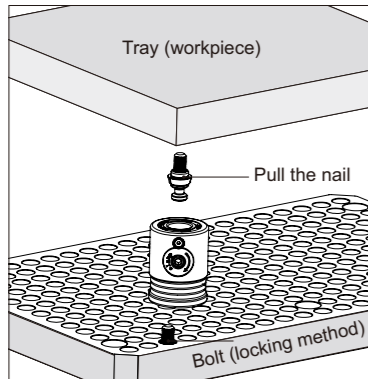

Double headed installation method

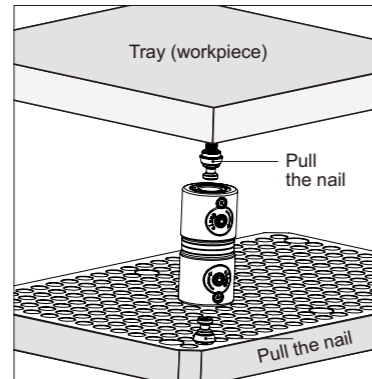

Flange type installation method

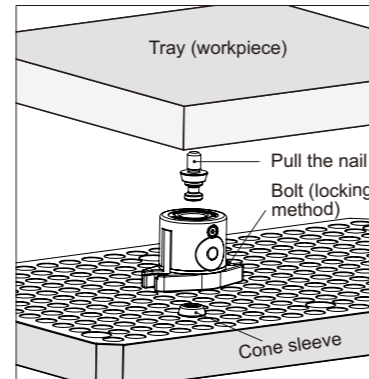

Manual cone pull down type connection method for various models:

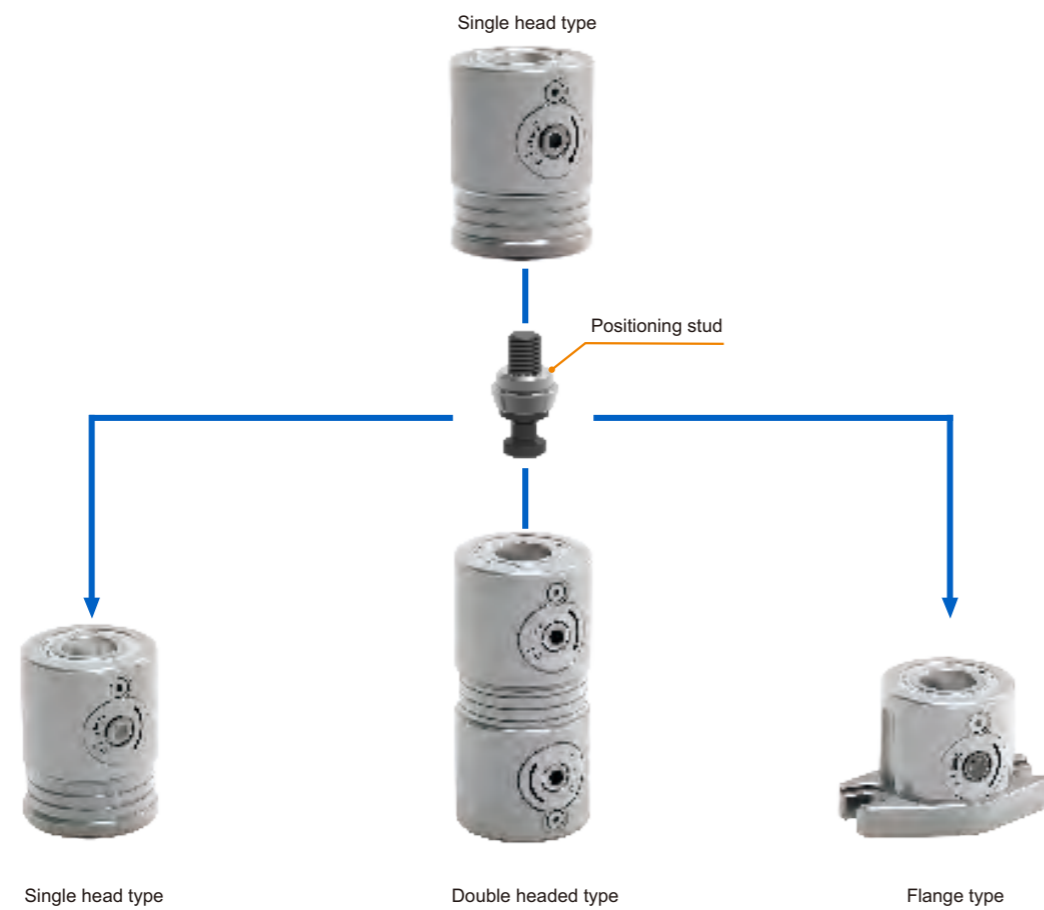

Note: Please use positioning pins when connecting the single head type

Manual cone pull-down type (single head type)



Product features:

- Manual unlocking and clamping;
- Material: Hardened stainless steel;
- Repetitive positioning accuracy<0.005mm;
- Has high clamping force.

Applicable industry:

- Suitable for the field of mold processing and assembly;
- Can be used to quickly adjust the center distance of the locator.

Outline dimensions:

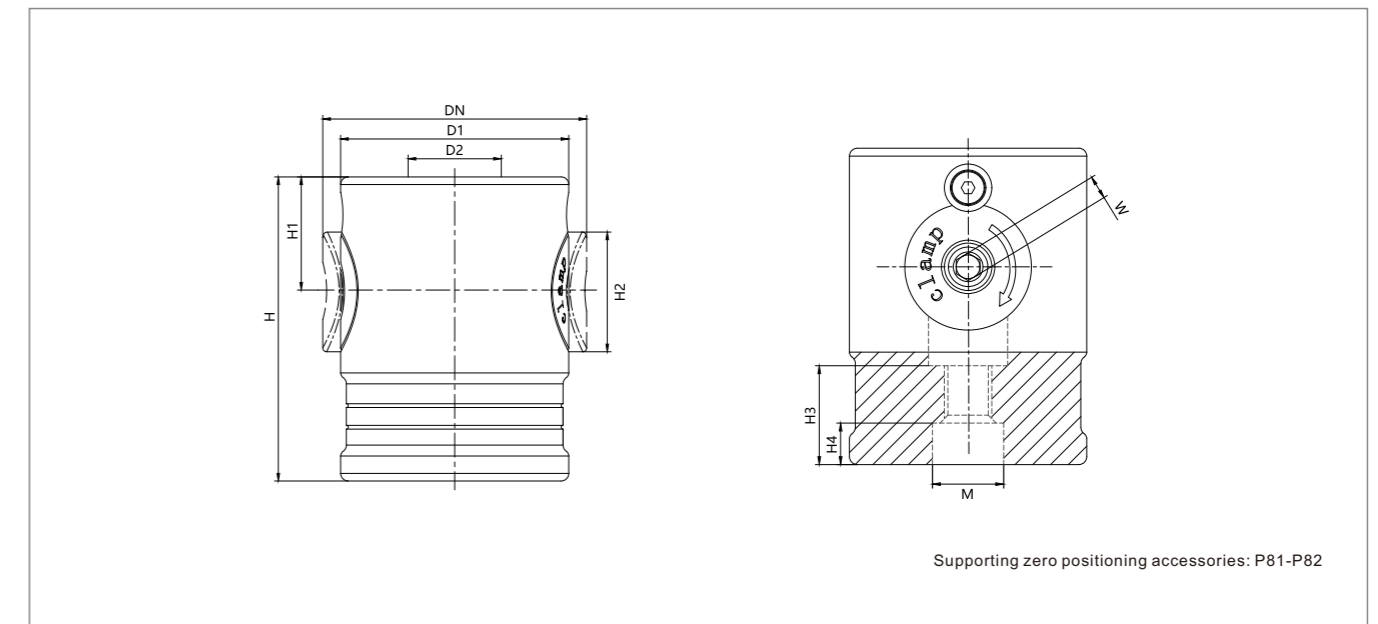

Supporting zero positioning accessories: P81-P82

Main parameter table:

Order Number	Unlocking method	clamping force (kN)	Allowable tightening torque (N-m)	Weight (kg)
CP40-50S	Manual operation	8	8	0.5
CP60-80S	Manual operation	15	22	1.6
CP80-100S	Manual operation	25	50	3.8

Order Number	DN	D1	ØD2	H (±0.01)	H1	H2	H3	H4	W	M (H7)
CP40-50S	46	40	12	50	20	22	18	7.5	4	12
CP60-80S	69	60	18	80	30	32	25	10.5	6	18
CP80-100S	91	80	22	100	40	44	31	12.5	8	22



### Manual cone pull-down type (double headed type)

**Product features:**

- Manual unlocking and clamping;
- Material: Hardened stainless steel;
- Repetitive positioning accuracy<0.005mm;
- Has high clamping force.

**Applicable industry:**

- Suitable for the field of mold processing and assembly;
- Can be used to quickly adjust the center distance of the locator.

**Outline dimensions:**

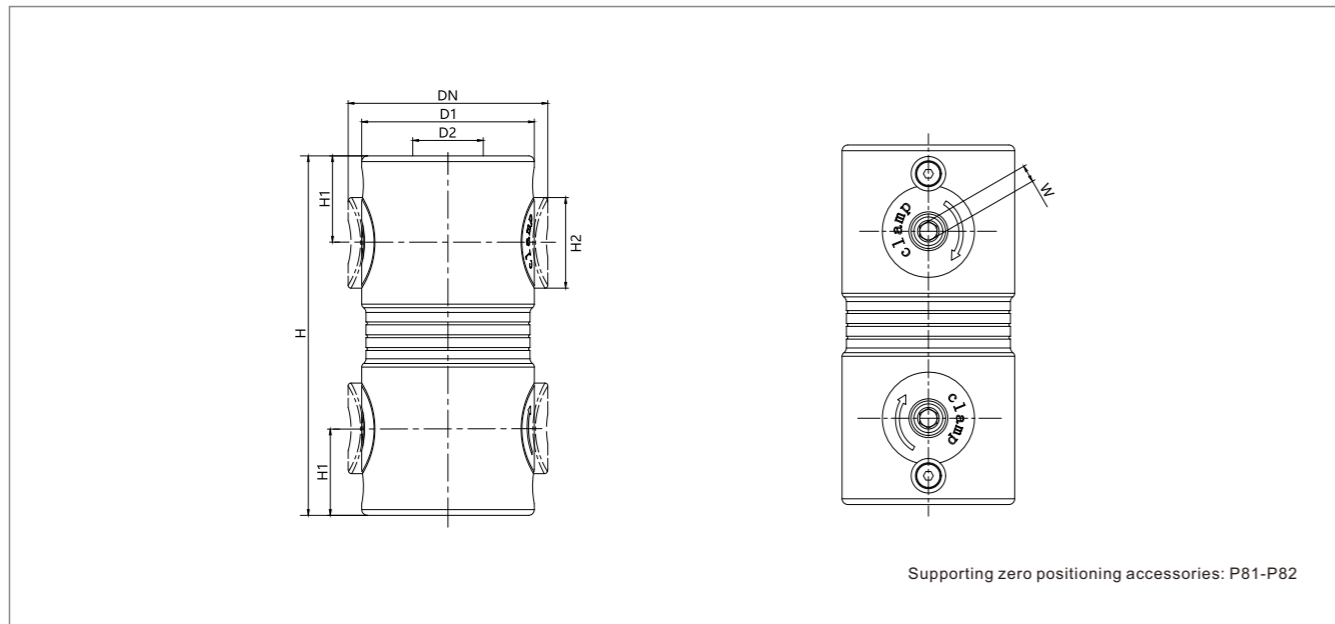

**Main parameter table:**

Order Number	Unlocking method	clamping force (kN)	Allowable tightening torque (N-m)	Weight (kg)
CP40-80D	Manual operation	8	8	2
CP60-125D	Manual operation	15	22	2.6
CP80-160D	Manual operation	25	50	5.8

Order Number	DN	D1	ØD2	H (±0.01)	H1	H2	W
CP40-80D	46	40	12	80	20	22	4
CP60-125D	69	60	18	125	30	32	6
CP80-160D	91	80	22	160	40	44	8



### Manual cone pull down type (flange type)

**Product features:**

- Manual unlocking and clamping;
- Material: Hardened stainless steel;
- Repetitive positioning accuracy<0.005mm;
- Has high clamping force.

**Applicable industry:**

- Suitable for the field of mold processing and assembly;
- Can be used to quickly adjust the center distance of the locator.

**Outline dimensions:**

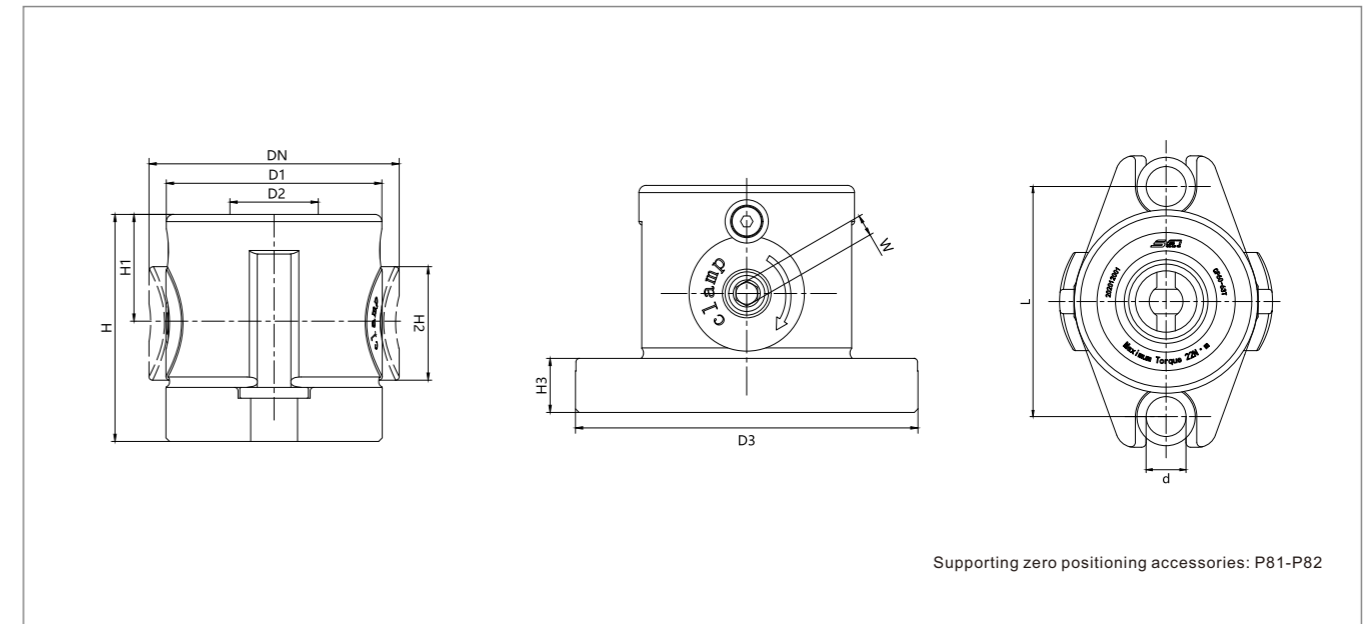

**Main parameter table:**

Order Number	Unlocking method	clamping force (kN)	Allowable tightening torque (N-m)	Weight (kg)
CP40-40T	Manual operation	8	8	0.8
CP60-63T	Manual operation	15	22	1.4
CP80-80T	Manual operation	25	50	3.3

Order Number	DN	D1	ØD2	D3	H (±0.01)	H1	H2	H3	L	d	W
CP40-40T	46	40	12	65	40	20	22	10	50	9	4
CP60-63T	69	60	18	95	63	30	32	15	75	13	6
CP80-80T	91	80	22	130	80	40	44	20	100	17	8

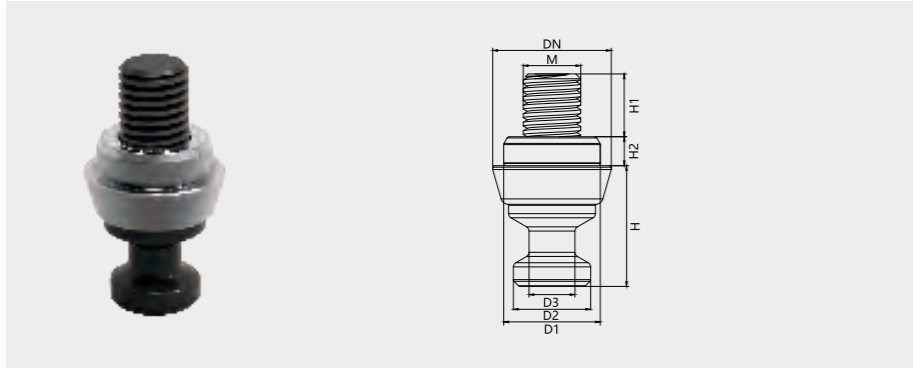

### Positioning stud

#### Product features:

- High precision requirements, surface hardening treatment;
- Plays a role in limiting the degrees of freedom in the X and Y directions;
- Suitable for manual cone pull down zero locator.

#### Main parameter table:

Order Number	Ø DN	Ø D1 (G6)	Ø D2	Ø D3	H	H1	H2	M	Weight (kg)
DW08-CP40	16	12	11	6.5	16.5	12	5	M8	0.02
DW12-CP60	25	20	16	9.5	25	18	6	M12	0.07
DW16-CP80	32	25	21	13	33	22	7.5	M16	0.15

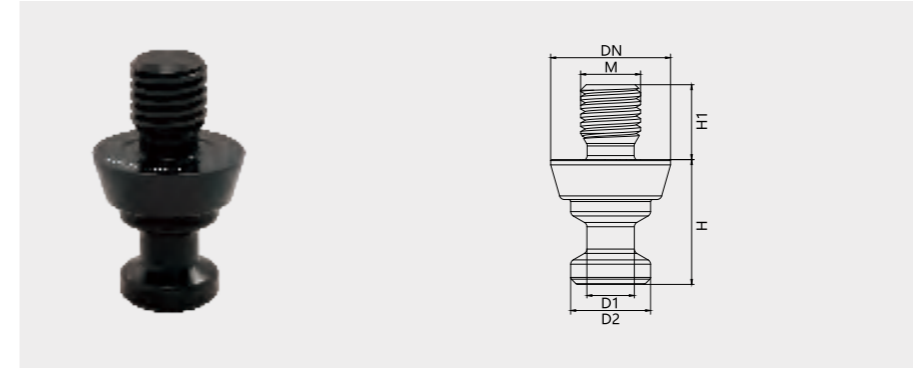

### Lock the zipper

#### Product features:

- Surface hardening treatment plays a role in increasing tension force;
- Ensure that the tray is fully positioned and avoid over positioning;
- Suitable for manual cone pull down zero locator.

#### Main parameter table:

Order Number	Ø DN	Ø D1	Ø D2	H	H1	M	Weight (kg)
SJ08-CP40	15.5	6.5	11	16.5	12	M8	0.018
SJ12-CP60	24.5	9.5	16	25	18	M12	0.065
SJ16-CP80	31.5	13	21	33	22	M16	0.14

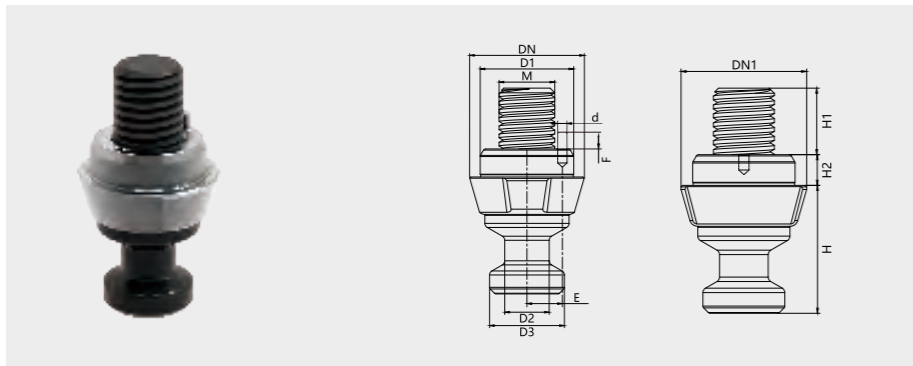

### Directional pull nail

#### Product features:

- Surface hardening treatment;
- Only restricting rotational freedom;
- Playing a directional role, the angle between the guide hole and the positioning edge is 45°;
- Suitable for manual cone pull down zero locator.

#### Main parameter table:

Order Number	Ø DN	Ø DN1	Ø D1 (G6)	Ø D2	Ø D3	E	F	Ø d	H	H1	H2	M	Weight (kg)
DX08-CP40	15.5	16	12	6.5	11	5.5	4	2	16.5	12	5	M8	0.02
DX12-CP60	24.5	25	20	9.5	16	7.6	4	2	25	18	6	M12	0.07
DX16-CP80	31.5	32	25	13	21	9.5	5	2	33	22	7.5	M16	0.15

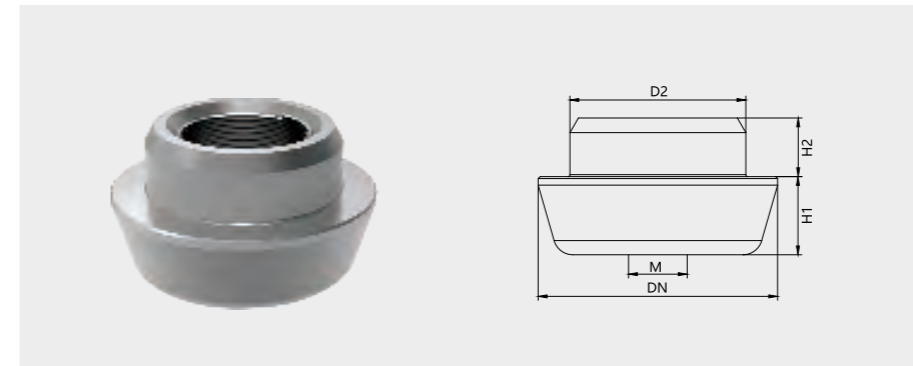

### Cone positioning sleeve

#### Product features:

- High precision requirements, surface hardening treatment;
- Plays a role in limiting the degrees of freedom in the X and Y directions;
- Suitable for manual cone pull down zero locator.

#### Main parameter table:

Order Number	Ø DN	Ø D2 (G6)	H1	H2	M	Weight (kg)
SD08-CP40	15.5	12	5	5	M10	0.008
SD12-CP60	24.5	20	8	6	M12	0.027
SD16-CP80	31.5	25	10	7.5	M20	0.051