

Manual quick change clamping system

The perfect combination of manual vise and manual zero positioning system=modular design for fast and strong locking

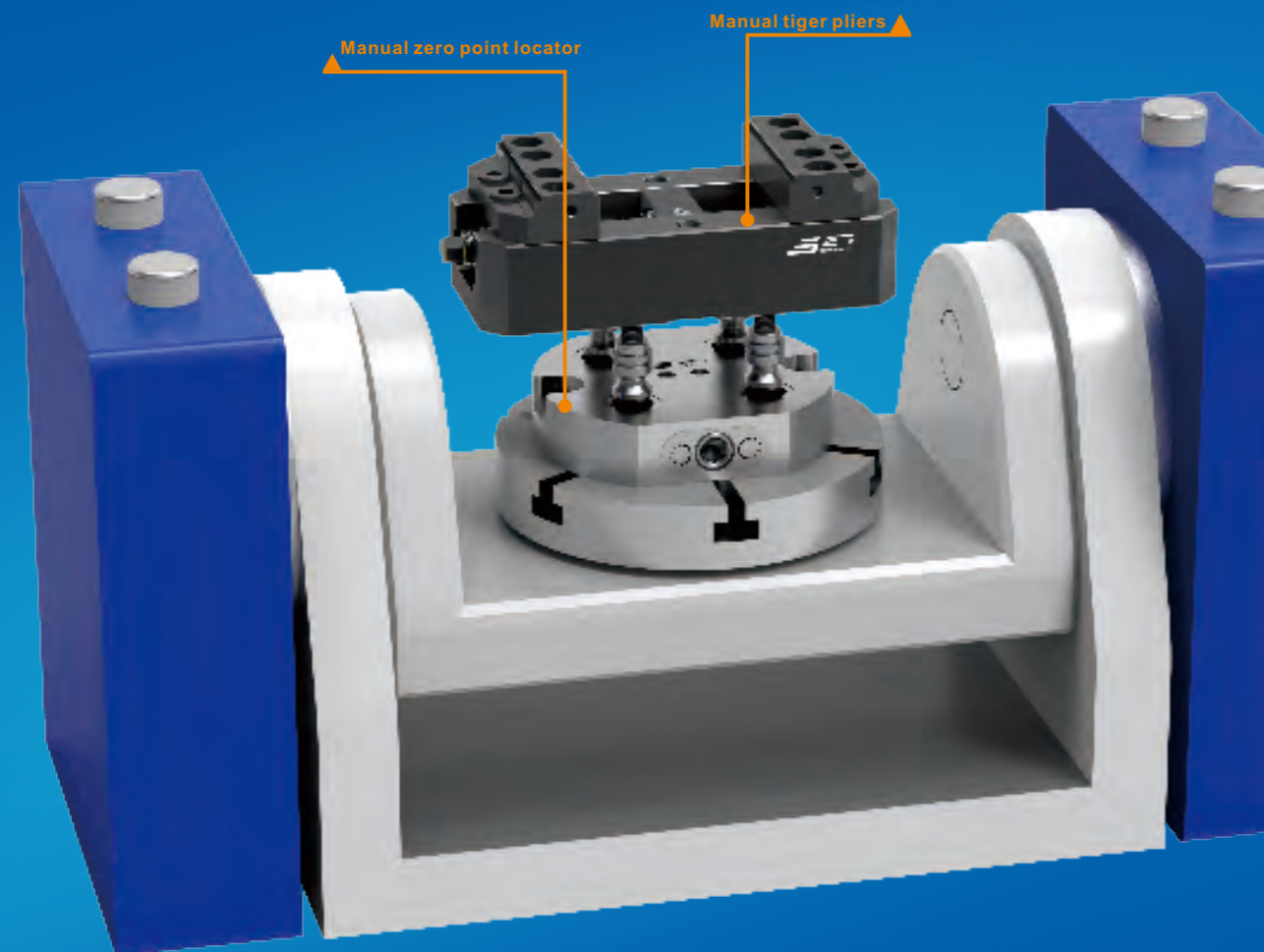

52mm manual four unit locator

Product features:

- Manual clamping and unlocking;
- Material: Stainless steel (or customer's choice);
- Surface and piston hardening treatment;
- Repetitive positioning accuracy<0.01mm;Maximum torque: 60N · m;
- Locking onto the T-shaped slot through the countersunk hole on the substrate makes installation simple.

Applicable industry:

- Suitable for metal or non-metal cutting fields;
- Suitable for machining with four axis and five axis CNC machine tools.



Outline dimensions:

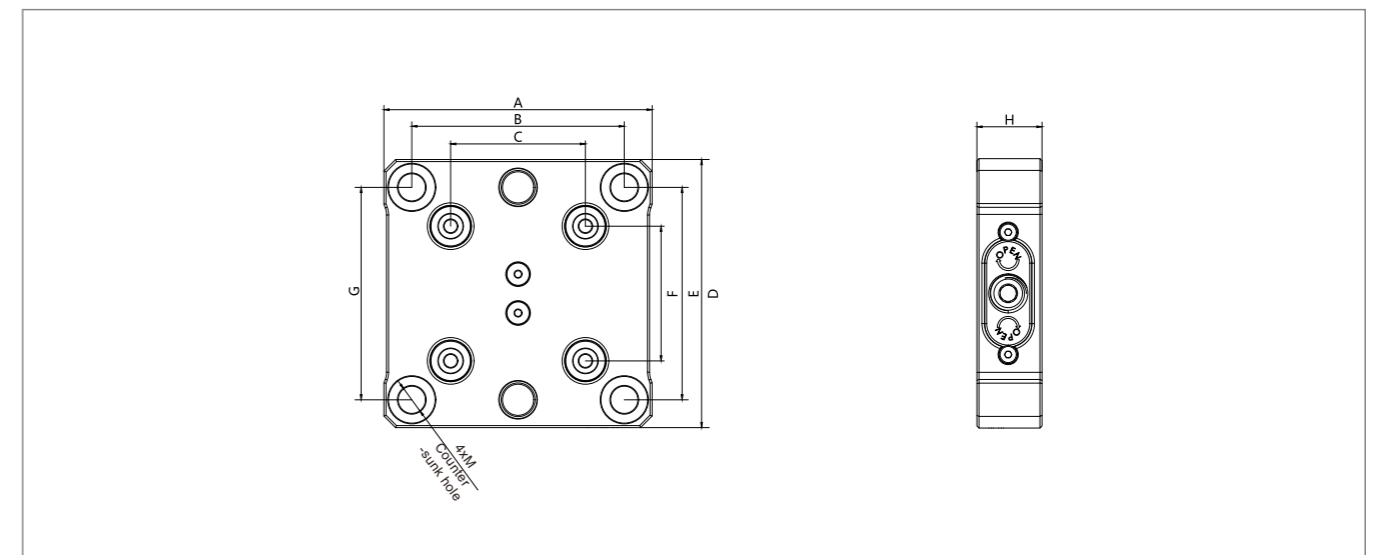

Main parameter table:

Order Number	Unlocking method	clamping force (kN)	Blowing debris	Weight(kg)
S4GWB-52A	Manual operation	5	×	2.3

x Not equipped with chip blowing function

Order Number	A	B	C	D	E	F	G	M	H
S4GWB-52A	103.5	82	52	103.5	82	52	82	M10	25

96mm manual four unit locator



Product features:

- Manual clamping and unlocking;
- Material: Stainless steel (or customer's choice);
- Surface and piston hardening treatment;
- Repetitive positioning accuracy<0.01mm;
- Maximum torque: 60N·m;
- Locking onto the T-shaped slot through the countersunk hole on the substrate makes installation simple.

Applicable industry:

- Suitable for metal or non-metal cutting fields;
- Suitable for machining with four axis and five axis CNC machine tools.

Outline dimensions:

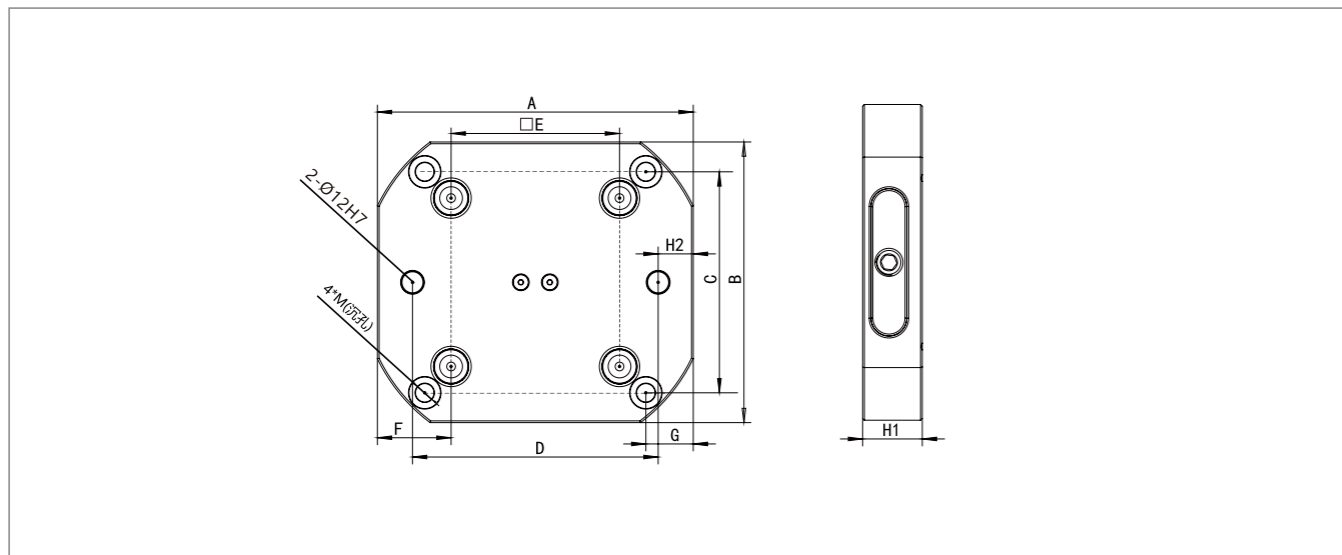

Main parameter table:

Order Number	Unlocking method	clamping force (kN)	Blowing debris	Weight(kg)
S4GWB-96C	Manual operation	10	x	6.2

x Not equipped with chip blowing function

Order Number	A	B	C	D	E	F	G	H1	H2	M
S4GWB-96C	180	160	126	140	96	42	27	34	20	M10

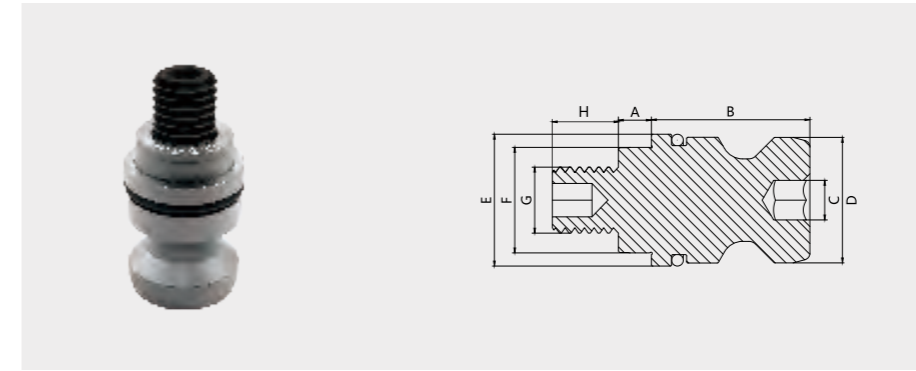

Manual locking pin

Product features:

- Hardening treatment;
- Plays a role in limiting the degrees of freedom in the X and Y directions;
- 52/96mm series manual base plate special pull nail.

Main parameter table:

Order Number	Match locator	A	B	C	D	E	F	G	H (H6)	Weight (kg)
SJJT-52	52mm series manual locator	5	19.6	SW6	15.2	16	12	M8	13	0.028
SJJT-96	96mm series manual locator	5	24	SW6	19	20	16	M10	15	0.045