

Tiger Claw Series

Compact design can maximize the utilization of the workspace in conjunction with the zero point locator, thereby maximizing the utilization rate of the machine tool

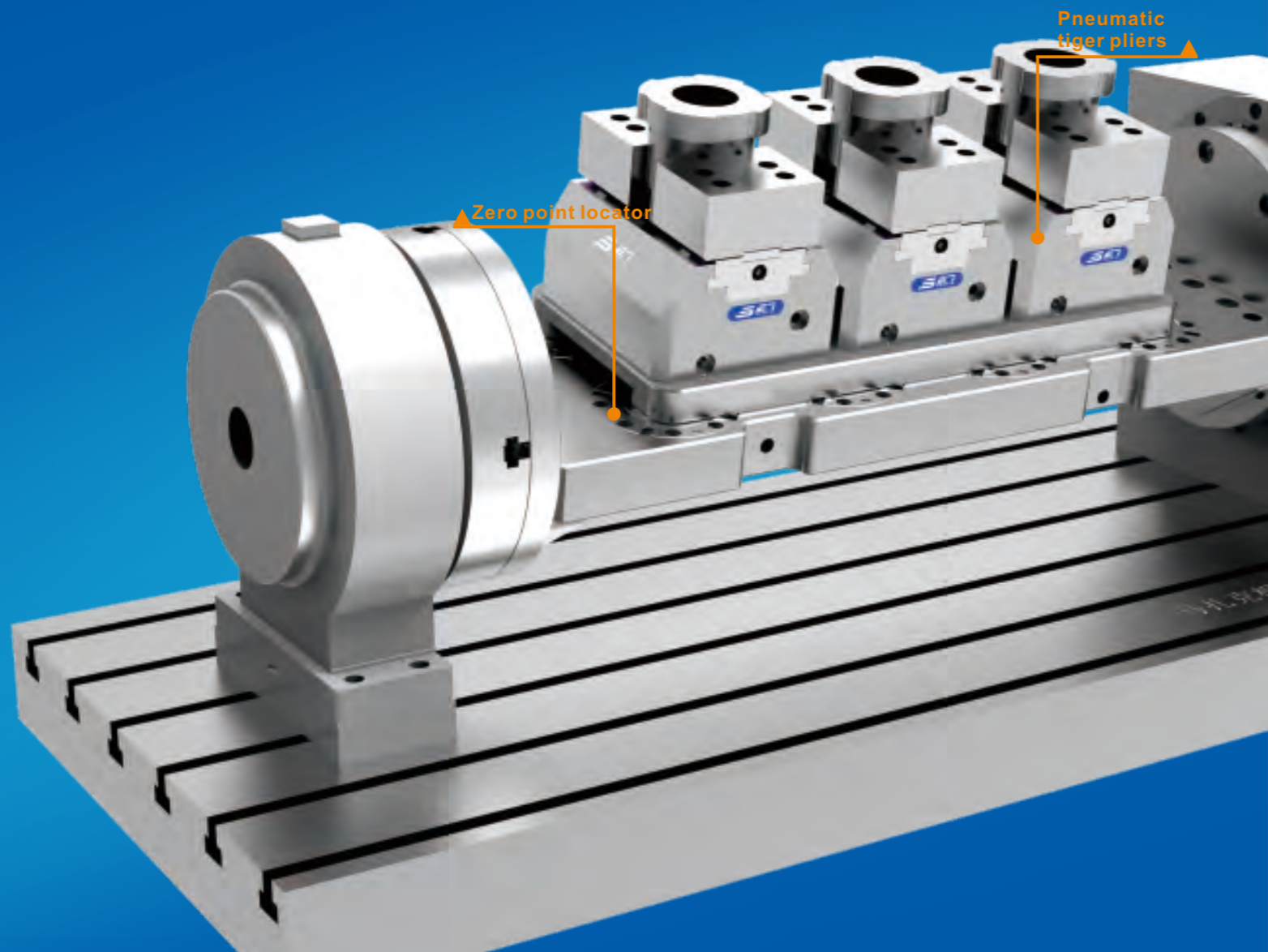

Manual vise series

52mm series

	M52S-102 52mm single station vise P89		M52S-130 52mm single station vise P89		M52S-170 52mm single station vise P89
	M52S-210 52mm single station vise P89		M52D-170 52mm dual station vise P90		M52D-210 52mm dual station vise P90

96mm series

	M96S-160 96mm single station vise P91		M96S-210 96mm single station vise P91		M96S-260 96mm single station vise P91
	M96S-310 96mm single station vise P91		M96S-360 96mm single station vise P91		M96D-260 96mm dual station vise P92
	M96D-310 96mm dual station vise P92		M96D-360 96mm dual station vise P92		

Pneumatic vise series

	Q100 Pneumatic tiger pliers (100 models) P93		Q140 Pneumatic tiger pliers (140 models) P93		Q200 Pneumatic tiger pliers (00 models) P93
---	--	---	--	---	---

52mm single station vise



Product features:

- Nail spacing: 52mm;
- Manual quick opening and locking, single station clamping;
- Material : Alloy steel;
- Surface and guide rail hardening treatment;
- Repetitive positioning accuracy $\leq\pm 0.01\text{mm}$;
- Stable clamping, effectively preventing the jaws from floating up and down;
- Suitable for quick switching with a 52mm manual four unit locator.

Applicable industry:

- Suitable for metal or non-metal cutting fields;
- Suitable for rough, smooth, and dovetail clamping.

Outline dimensions:

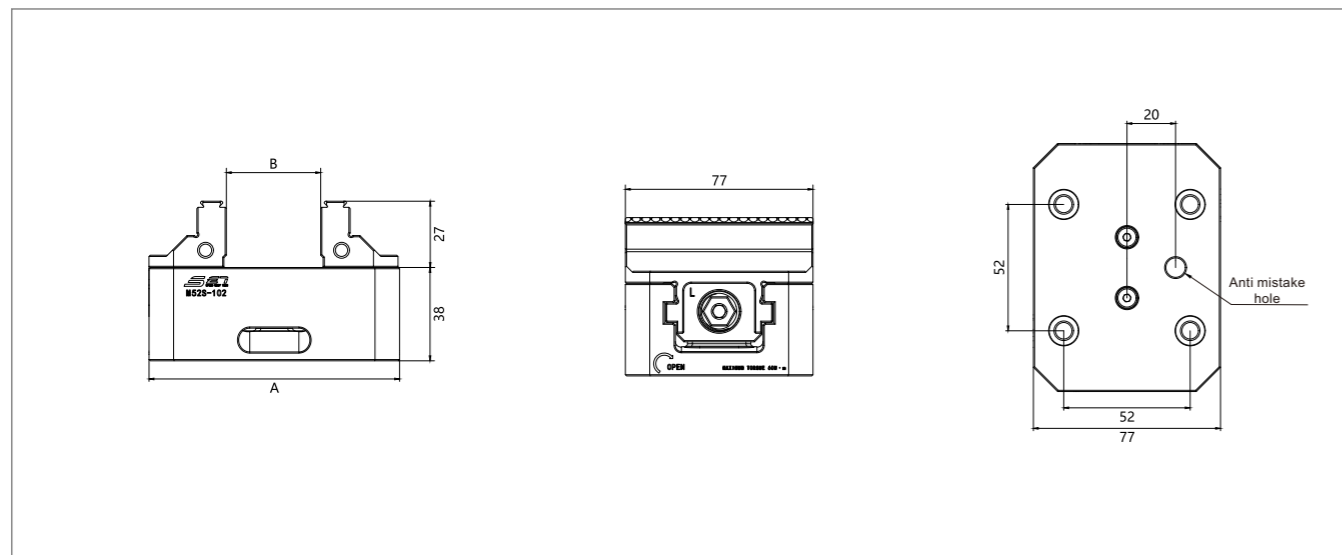

Main parameter table:

Order Number	Unlocking method	clamping force (kN)	Maximum operating torque (N·m)	Weight(kg)
M52S-102	Manual operation	13.5	60	2.3
M52S-130	Manual operation	13.5	60	2.9
M52S-170	Manual operation	13.5	60	3.5
M52S-210	Manual operation	13.5	60	4.2

Order Number	A	B
M52S-102	102	39
M52S-130	130	67
M52S-170	170	107
M52S-210	210	147

52mm dual station vise



Product features:

- Nail spacing: 52mm;
- Manual quick opening and locking, single station clamping;
- Material: Alloy steel;
- Surface and guide rail hardening treatment;
- Repetitive positioning accuracy $\leq\pm 0.01\text{mm}$;
- Stable clamping, effectively preventing the jaws from floating up and down;
- Suitable for quick switching with a 52mm manual four unit locator.

Applicable industry:

- Suitable for metal or non-metal cutting fields;
- Suitable for rough, smooth, and dovetail clamping.

Outline dimensions:

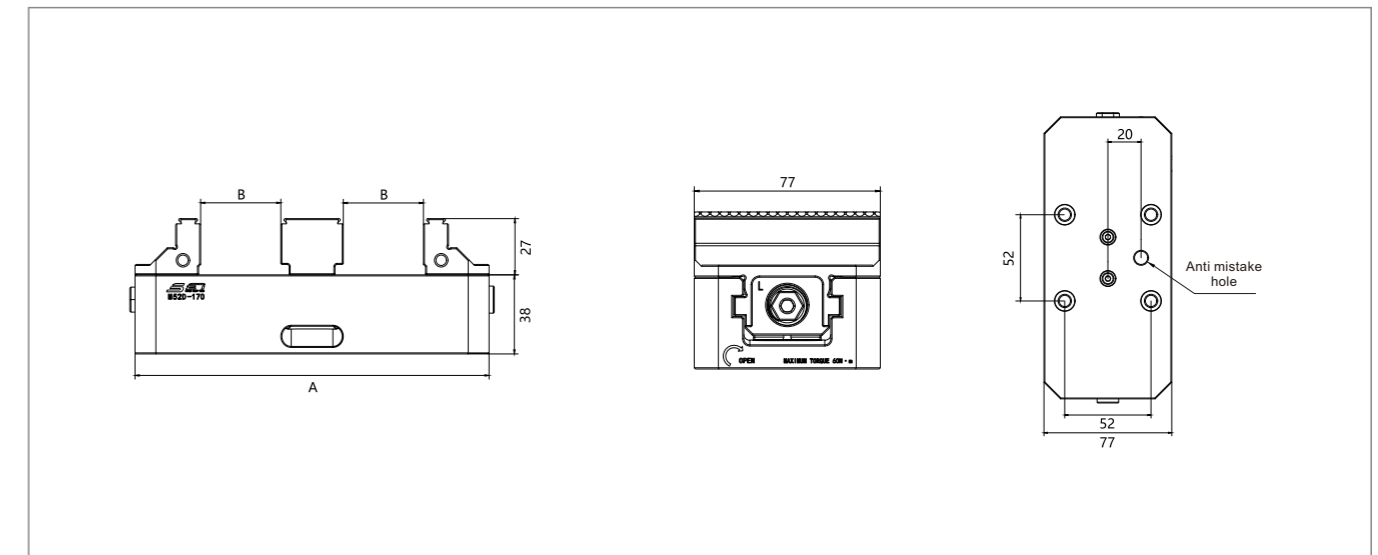

Main parameter table:

Order Number	Unlocking method	clamping force (kN)	Maximum operating torque (N·m)	Weight(kg)
M52D-170	Manual operation	13.5	60	4
M52D-210	Manual operation	13.5	60	4.7

Order Number	A	B
M52D-170	170	38
M52D-210	210	58

52mm single station vise



Product features:

- Nail spacing: 96mm;
- Manual quick opening and locking, single station clamping;
- Material: Alloy structural steel;
- Surface and guide rail hardening treatment;
- Repetitive positioning accuracy $<\pm 0.01\text{mm}$;
- Precise fit to reduce the up and down movement of the jaws;
- Suitable for rough, smooth, and dovetail clamping.

Applicable industry:

- Suitable for metal or non-metal cutting fields;
- Suitable for quick switching with a 96mm manual four unit locator.

Outline dimensions:

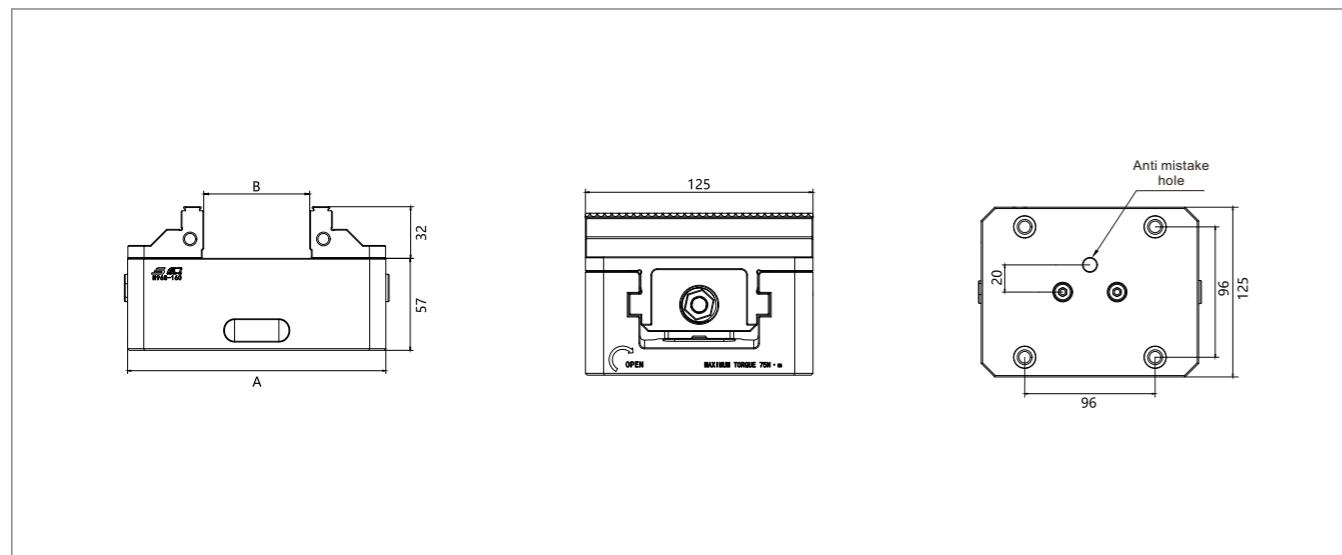

Main parameter table:

Order Number	Unlocking method	clamping force (kN)	Maximum operating torque (N·m)	Weight(kg)
M96S-160	Manual operation	15	75	8.4
M96S-210	Manual operation	15	75	10.2
M96S-260	Manual operation	15	75	12
M96S-310	Manual operation	15	75	14
M96S-360	Manual operation	15	75	15.9

Order Number	A	B
M96S-160	160	66
M96S-210	210	116
M96S-260	260	166
M96S-310	310	216
M96S-360	360	266

96mm dual station vise



Product features:

- Nail spacing: 96mm;
- Manual quick opening and locking, dual station clamping;
- Material: Alloy structural steel;
- Surface and guide rail hardening treatment;
- Repetitive positioning accuracy $<\pm 0.01\text{mm}$;
- Precise fit to reduce the up and down movement of the jaws;
- Suitable for rough, smooth, and dovetail clamping.

Applicable industry:

- Suitable for metal or non-metal cutting fields;
- Suitable for quick switching with a 96mm manual four unit locator.

Outline dimensions:

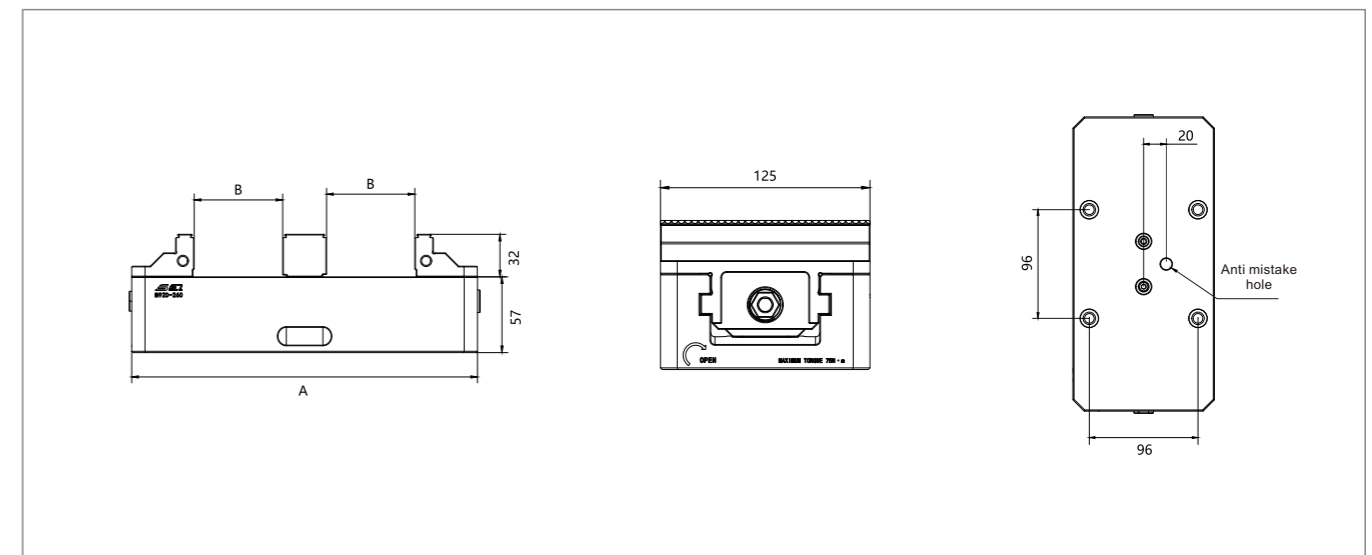

Main parameter table:

Order Number	Unlocking method	clamping force (kN)	Maximum operating torque (N·m)	Weight(kg)
M96D-260	Manual operation	15	75	13.3
M96D-310	Manual operation	15	75	15.1
M96D-360	Manual operation	15	75	16.8

Order Number	A	B
M96D-260	260	66
M96D-310	310	91
M96D-360	360	116

Pneumatic tiger pliers



Product features:

- The gas source is turned on, the spring is mechanically locked, and it has a boosting function;
- Material: Hardened stainless steel;
- Surface and guide rail hardening treatment;
- Repetitive positioning accuracy<0.01mm;
- Maximum working pressure: 9 bar;
- Used in conjunction with the zero point locator at the bottom;

Applicable industry:

- Suitable for metal or non-metal processing fields;
- Suitable for smooth, profile, dovetail, and toothed clamping.

Outline dimensions:

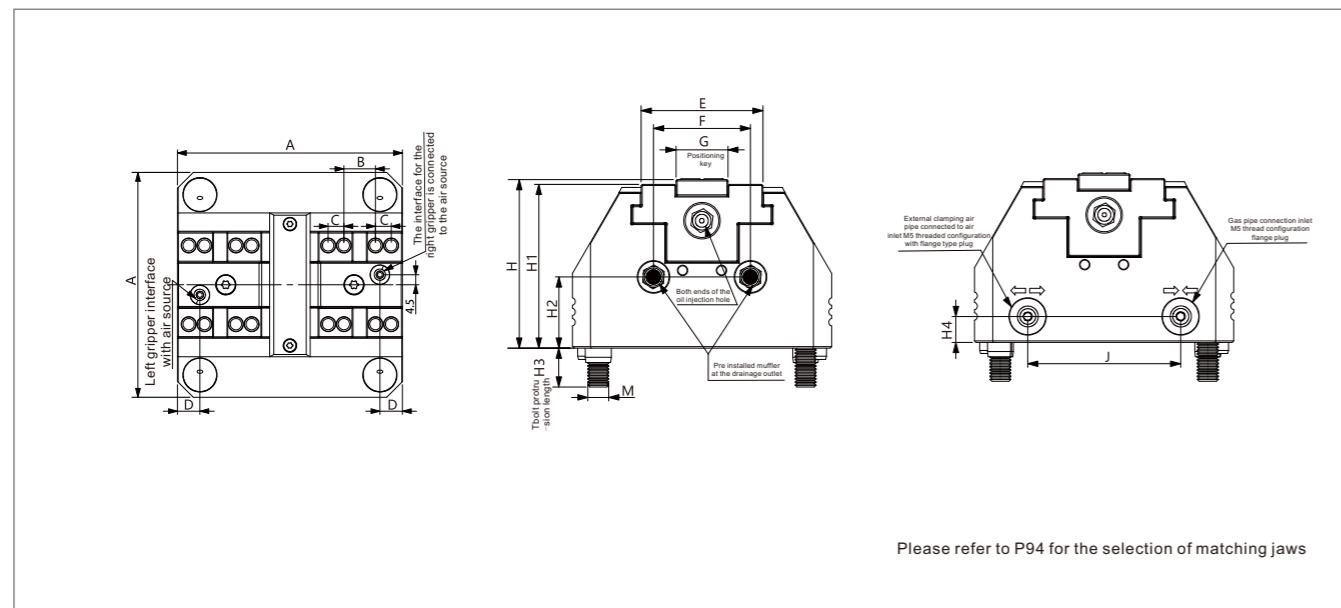

Main parameter table:

Order Number	Unlocking method	Repetitive positioning accuracy (mm)	clamping force (kN)	Single claw stroke (mm)	Weight(kg)
Q100-T/C/Y/F	Gas pressure	0.01	2.5~6.5	2	4
Q140-T/C/Y/F	Gas pressure	0.01	5~9	3	7
Q200-T/C/Y/F	Gas pressure	0.02	26~35	7	24

Order Number	A	B	C	D	E	F	G	J	H	H1	H2	H3	H4	M
Q100-T/C/Y/F	100	14	7	10	47	37.4	20	59	65	63.2	27.5	15	10	M8
Q140-T/C/Y/F	140	20	10	18	68	54	28	80	70.5	68.7	31	15	13.5	M8
Q200-T/C/Y/F	200	24	12	38	102	90	45	129	90.2	88.7	45	15	17.5	M8

Note: Pneumatic vises can be matched with various jaws (P94). In the order number, T: stepped jaw, C: toothed jaw, Y: dovetail jaw, F: profiled jaw.

Pneumatic vise matching jaws:

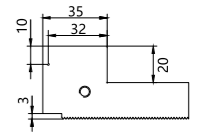
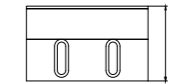
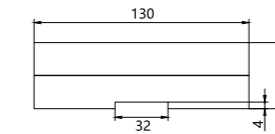

Jaw name	Order number	External dimensions (mm)	Texture of material	Clamping range (mm)	Individual weight (kg)
Step type jaw	T80	130*80*40	High strength structural steel	17-58	2

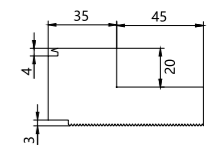
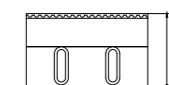
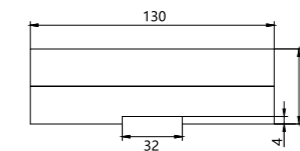

Jaw name	Order number	External dimensions (mm)	Texture of material	Clamping range (mm)	Individual weight (kg)
Toothed jaw	C80	130*80*40	High strength structural steel	15-58	2

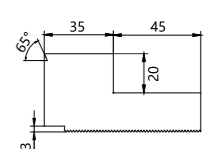
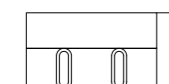
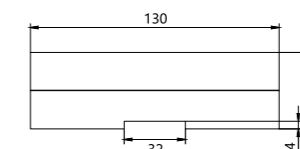

Jaw name	Order number	External dimensions (mm)	Texture of material	Clamping range (mm)	Individual weight (kg)
Swallowtail jaw	Y80	130*80*40	High strength structural steel	15-58	2

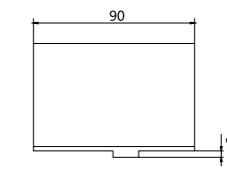
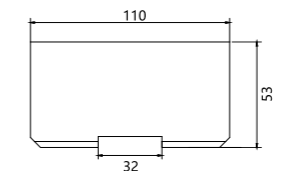

Jaw name	Order number	External dimensions (mm)	Texture of material	Clamping range (mm)	Individual weight (kg)
Imitation jaw	F53	110*90*53	Aluminium alloy	0-80	1.25